

SPECIFICATIONS

FOR THE *Construction of the South Talbot Road Drain and Holden Outlet*

DRAIN IN *the South Talbot Road and the 6th Concession Road, and across*
IN THE *the 5th* CONCESSION OF THE TOWNSHIP OF

Sandwich South COUNTY OF ESSEX, ONTARIO.

THE DRAIN SHALL COMMENCE AT *a point about 800 feet west of the Oldcastle Road and on the*

North SIDE OF THE *said South Talbot Road* AND BE

CONTINUED TO ITS OUTLET ~~AT STAKE~~ *into the Merrett Creek Drain and into the Township of Sandwich West as shewn on plan and profile of the same*

~~A DISTANCE OF~~ RODS.

This drain shall be repaired and improved in accordance with the profile and specifications attached hereto.

ALIGNMENT

The general course of the drain to be constructed or repaired will be shown on plan accompanying these Specifications but the exact alignment will be governed by the Specifications or as may be further directed by the Commissioners or Engineer in charge of this drain.

BOTTOM AND TOP WIDTHS AND SLOPES

The bottom widths of this drain will be not less than shewn on Plan as follows:

From stake	0	to stake	19	bottom width	3'-0" feet
" "	19	" "	34	" "	3'-6" "
" "	34	" "	69	" "	4'-0" "
" "	69	" "	74	" "	5'-0" "

(6 Con. Branches)

41+122

The top width shall be not less than would be derived by giving the sides a slope of $1\frac{1}{4}$ foot horizontal to 1 foot vertical with the given bottom widths.

Side slopes shall have even and straight faces from the top of the drain to the bottom thereof, and the inclinations and batter shewn on profile and specifications. Any shoulders, overhanging banks or uneven slopes will have to be removed before work will be accepted.

No unnecessary bends or deviations will be permitted. The centre line of grade bottom shall be kept in a straight line as far as possible, sharp curves or bends in the drain shall be rounded to a radius ~~not exceeding~~ ²⁰ feet and any extra cutting that may be required for widening the drain shall be taken from that side which will have a tendency to straighten the drain. Short irregular bends must be removed.

Excavation and Disposal of Earth

The drain shall be excavated to conform with the data shewn on profile. The depths are to be taken from hubs about level with the surface of the ground where the respective stakes have been planted and are deduced from the levels taken along the drain course.

Should any of these stakes be lost and new stakes planted the depths given from the surface or hubs at the new stakes shall conform to the grade line for the bottom of the drain.

The bottom of the drain when completed must not be above the required bottom grade of the drain and the bottom and top widths and slopes shall conform with the grades, widths, etc., shewn on Profile and Specifications.

The excavated material shall be cast *in the field adjoining the drain on the South Talbot Road and the 6th Concession Road, and on the side opposite to the side on which the fence is erected where the drain passes through the fields*

and spread over a space of ⁶⁶ feet, leaving a berm of ⁶ feet between the side of the drain and the excavated material. All brush, logs, rubbish of all kinds in the line of ditch, and three feet from the sides thereof shall be taken out and burnt to ashes, and where the earth is to be spread the space shall be cleared of logs, brush, etc., and burned. All trees and stumps that encroach on the side or slopes of the drain shall be removed.

The earth shall be spread in a good and workmanlike manner to the satisfaction of the Commissioners.

Where the earth shall be cast on the Public Road it shall be spread over a space of feet and crowned in the centre as may be directed by the Commissioners.

Fences.

Fences required to be removed during the construction of the drain shall be rebuilt as nearly as possible on the line where removed from and in as good condition as before removal so far as the material removed shall permit of.

Openings made by removal of fences shall be guarded until replaced to prevent trespassing of stock on adjacent fields.

Obstructing Drains.

No private or other drains shall be obstructed or filled in by earth excavated from the drain. At the outlet of side line or private drains the earth shall be cleaned out and drain deepened for a width of three feet back from outlet into the drain.

Bridges.

Where bridges are required to be removed during construction they shall be replaced within twenty-four hours after removal so as to cause no inconvenience to owners.

The contractor shall be liable for all damages caused by him not keeping the road in a state for travel while the work is going on and until it has been taken off his hands by the Engineer in charge of the repairs.

The Engineer shall be the sole judge of the true intent and meanings of any part of the plans, profile and specifications and shall have the right to correct any error that may appear in the plan, profile and specifications should any errors occur or make any alterations or changes that may appear necessary without in any way violating or rendering the Contract null and void.

No charge for extras shall be allowed unless on the written order of the Engineer or Commissioners on the Drain.

60 per cent. of the value of the work done shall be paid monthly as the work progresses and the remaining 40 per cent. shall be paid within one month after the satisfactory completion of the work as certified by the Engineer.

All work shall be done in conformity with the plans and specifications and to the entire satisfaction of the Engineer and Commissioners on the work.

Owen McKay
Civil Engineer
Marksville August 14th 1915

Walkerville, July 9th, 1915.

Stakes 200 ft apart.

Estimated Cost of proposed repairs and improvements
of the South Talbot and Holden Outlet Drains in the
the Township of Sandwich South, County of Essex, Ont.
Cost of Construction.

From commencement at stake 0 about 800 feet
west of Oldcastle Road as per plan to stake 19 plus
27 feet at the 6th Concession Road.....

232 lin rods of ditching @ \$1.47cts per rod 345.68
Stake 19 plus 27 ft to stake 41 plus 30 ft
at Holden Outlet Drain,

267 lin rods of ditching @ \$1.51 403.17
Stake 41 plus 30 ft to stake 69 plus 70 ft
at bridge on Town Line Road

344 rods @ \$1.45 per rod

Stake 69 plus 70 to stake 74 on 4th Con Rd
Sandwich West.

50 rods of drain @ 55¢ per rod 28.50

Branch on East side of 6th Con Road
from Holden Outlet Drain @ 41 plus 30'
to Merrick Creek at stake 41 plus 22

504½ lin rods of drain @ \$1.08 per rod 544.86
Cost of excavation 1821.01

Allowances to Owners for earth spread
on land as per schedule attached

101.16

Extra allowances to Contractor for long haul
in front of Buildings, Orchards etc

50.00

Cleaning out drain at turn of Oldcastle
to South Talbot Drain

5.00

Moving and replacing fences as per Plan
and Specifications
970 lin rods @ 15 ¢

145.50

~~Allowances for bridges to access to road~~ 40.00

Allowances for damages to growing crops
meadows &c, if any damages should occur 30.00

	Amount
[Incidental charges]	
Court of Revision	18.00
Publishing By-Law 2	20.00
Clerks Fees	30.00
Surveys plans and reports	57.00
Expenses on survey	17.25
Selling and superintending work	80.00

Total incidentals

Total Estimated Cost of Work

331.66

~~371.66~~

222.25

\$2874.92

~~2414.92~~
2874.92

Oliver McFarlane
Civil Engineer

Walkerville, July 9th, 1915.

Stakes 200 ft apart.

Estimated Cost of proposed repairs and improvements
of the South Talbot and Holden Outlet Drains in the
the Township of Sandwich South, County of Essex., Ont.
Cost of Construction. []

From commencement at stake 0 about 800 feet
west of Oldcastle Road as per plan to stake 19 plus
27 feet at the 6th Concession Road.....

232 lin rods of ditching @ \$1.47cts per rod 345.68
Stake 19 plus 27 ft to stake 41 plus 30 ft
at Holden Outlet Drain,
267 lin rods of ditching @ \$1.51 403.17
Stake 41 plus 30 ft to stake 69 plus 70 ft
at bridge on Town Line Road

344 rods @ \$1.45 per rod

Stake 69 plus 70 to stake 74 on 4th Con Rd
Sandwich West.

50 rods of drain @ 55¢ per rod 28.50

Branch on East side of 6th Con Road
from Holden Outlet Drain @ 41 plus 30'
to Merrick Creek at stake 41 plus 22

504½ lin rods of drain @ \$1.08 per rod 544.86
Cost of excavation 1821.01

[Allowances to Owners for earth spread]

on land as ~~per schedule attached~~ 101.16

Extra allowances to Contractor for long haul
in front of Buildings, Orchards etc 50.00

Cleaning out drain at turn of Oldcastle
to South Talbot Drain 5.00

Moving and replacing fences as per Plan
and Specifications 145.50
970 lin rods @ 15 ¢

provided

Walkerville, July 12th 1915.

To The Reeve and Council of
The Township of Sandwich South.

Gentlemen.—

In conformity with your instructions I have taken measurements and levels on the South Talbot Road and Holden Outlet Drains in the Township of Sandwich South, and beg to report thereon as follows:

I find that the portion of the drain along the Oldcastle Road and the South Talbot Road to stake marked 0 about $48\frac{1}{2}$ rods west of the Oldcastle Road will require some sediment to be removed around the bend where the drain enters the South Talbot Road to place this portion of the drain in a fair state of repair.

The remaining portion of the drain is badly filled with sediment washed into it from line ditches and caving of the banks and is also partly filled with weeds and other obstructions which retard the flow of water passing through the drain and ~~can~~ causes overflow of the adjoining lands as complained of by some of the ratepayers of this drain.

I would therefore recommend that this drain shall be repaired, deepened and otherwise improved from stake 0 a distance of $48\frac{1}{2}$ rods west of the Oldcastle Road to the Sixth Concession Road.

thence along the Sixth Concession Road to the Holden Outlet Drain.

thence along the Holden Outlet Drain to the centre of the West Town Line Road where it joins the Fourth Concession Drain.

As this last mentioned drain is partly filled with sediment washed in from the Holden and other drains and also by Stock pasturing along a portion of the drain, I would also recommend that the Fourth Concession Drain should be cleaned out from the West Town Line drain to stake 74 a distance of about $56\frac{1}{2}$ rods where there is a good and sufficient outlet. The repairs shall be done in accordance with the accompanying plan and

Specifications and to the satisfaction of the Commissioners appointed by the Councillors to superintend this work.

Sharp bends shall be removed by excavating the earth on that side of the drain which will have a tendency to straighten the bends..

I would also recommend that the drain on the east side of the sixth concession road from the Holden Outlet Drain to ^{Crunk} Merrick shall also be repaired and improved in accordance with Profile and Specifications.

I have provided in my estimate for allowance to owners for earth spread on land also for extra allowance to the Contractor for hauling earth excavated from the drains in front of buildings orchards, &c to a distance not exceeding 60 rods, for removing and replacing fences and for damages to growing crops or other damages, if such occur during the construction of the drain.

Where the drain passes along the Public highway the earth shall be cast on the side next the fence and spread in a good and workmanlike manner over a space of 4 rods in width, having a berm of 5 feet between the excavated material and the side of the drain.

Where the drain passes through the field the earth shall in general be cast on the side opposite to that on which the fence is erected. Where there are no fences the earth shall be cast on either or both sides of the drain as the Commissioners may direct doing no unnecessary damages to meadows, growing crops, &c.

Where the fence is too close to the ditch to allow for properly sloping the drain, the fence shall be removed and replaced at a distance not exceeding 3 feet from the edge of the drain after completion thereof.

I have also provided in my estimate for damages for earth spread on land where the drain has been cleaned out in Sandwich West..

I have not assessed the cost of the repairs of the 4th Concession Drain together with allowances for earth spread on land to the lands and roads in Sandwich West, as the Assessment which might properly be charged on the lands in Sandwich West would not reimburse Sandwich South for cost of duplicate report,

Plans, Estimates and By-Law.

As all the owners on this drain with two exceptions have erected permanent bridges to give access from their property to the Public Highway, I have taken this into consideration in making my Assessment and have placed the sum of \$40.00 in my Assessment required to make the necessary repairs to these bridges to give access to these bridges in the N.W. $\frac{1}{4}$ of Lot 2 and N.W. $\frac{1}{4}$ of 3. *the Owners*

My Total estimate of this work is ~~\$2374.92~~ ^{2374.92}

Of this amount I have charged the Municipality of Sandwich South with the sum of ~~\$574.92~~ ^{714.92} for Benefit and outlet for Roads and the remaining cost amounting to ~~\$1799.00~~ ^{1660.00} on lands which will be benefited by the drain or which may use it for an outlet for these waters as per Assessment, Schedules, etc.

I would recommend that this drain shall be hereafter maintained in the same relative proportion as herein assessed unless future changes in the Drainage area should render changes in Assessment necessary.

Accompanying this report you will please find Plan & Profile Specifications, Estimate of Cost and Schedule of Assessment and Allowances, all of which is respectfully submitted.

I have the honor to be,

Your obedient servant.

Chas M. Hay

C.E.

TOWNSHIP OF SANDWICH SOUTH

CLERK'S OFFICE

822

JOHN MCAULIFFE
CLERK

RURAL ROUTE NO. 3
MAIDSTONE, ONT.

Oct. 16th 1916

Mr Webster

Some of the figures on the Profile are somewhat blurred, especially on the part of the work that the Contractor has about completed. I am unable to make out the bottom with the from stake 19 to 34. but I have put it down as 3' 6". However the part that mostly concerns you is the 6th Concession Graded where Mr. Remand is about to commence work and the most of the cuts are discernable, on that part of the profile.

Yours Truly

John McAuliffe

P.S. I have given Mr. Remand the cuts on the 6th Concession branch of the Drain.

J. M.

Walkerville, July 12th 1915.

To The Reeve and Council of
The Township of Sandwich South.

Gentlemen.--

In conformity with your instructions I have taken measurements and levels on the South Talbot Road and Holden Outlet Drains in the Township of Sandwich South and beg to report thereon as follows:

I find that the portion of the drain along the Oldcastle Road and the South Talbot Road to stake marked 0 about 48½ rods west of the Oldcastle Road will require some sediment to be removed around the bend where the drain enters the South Talbot Road to place this portion of the drain in a fair state of repair.

The remaining portion of the drain is badly filled with sediment washed into it from line ditches and caving of the banks and is also partly filled with weeds and other obstruction which retard the flow of water passing through the drain and can cause overflow of the adjoining lands as complained of by some of the ratepayers of this drain.

I would therefore recommend that this drain shall be repaired, deepened and otherwise improved from stake 0 a distance of 48½ rods west of the Oldcastle Road to the Sixth Concession Road.

thence along the Sixth Concession Road to the Holden Outlet Drain.

thence along the Holden Outlet Drain to the centre of the West Town Line Road where it joins the Fourth Concession Drain.

As this last mentioned drain is partly filled with sediment washed in from the Holden and other drains and also by Stock pasturing along a portion of the drain, I would also recommend that the Fourth Concession Drain should be cleaned out from the West Town Line drain to stake 74 a distance of about 56½ rods where there is a good and sufficient outlet. The repairs shall be done in accordance with the accompanying plan and

Notices July 14
Report Road July 24
By Laws Council Aug 10
Committee of Revision Sept 14

Specifications and to the satisfaction of the Commissioners appointed by the Councillors to superintend this work.

Sharp bends shall be removed by excavating the earth on that side of the drain which will have a tendency to straighten the bends.

I would also recommend that the drain on the east side of the sixth concession road from the Holden Outlet Drain to Herrick shall also be repaired and improved in accordance with Profile and Specifications.

I have provided in my estimate for allowance to owners for earth spread on land also for extra allowance to the Contractor for hauling earth excavated from the drains in front of buildings orchards, &c to a distance not exceeding 60 rods, for removing and replacing fences and for damages to growing crops or other damages, if such occur during the construction of the drain.

Where the drain passes along the Public highway the earth shall be cast on the side next the fence and spread in a good and workmanlike manner over a space of 4 rods in width, having a berm of 5 feet between the excavated material and the side of the drain.

Where the drain passes through the field the earth shall in general be cast on the side opposite to that on which the fence is erected. Where there are no fences the earth shall be cast on either or both sides of the drain as the Commissioners may direct doing no unnecessary damages to meadows, growing crops, &c.

Where the fence is too close to the ditch to allow for properly sloping the drain, the fence shall be removed and replaced at a distance not exceeding 3 feet from the edge of the drain after completion thereof.

I have also provided in my estimate for damages for earth spread on land where the drain has been cleaned out in Sandwich West.

I have not assessed the cost of the repairs of the 4th Concession Drain together with allowances for earth spread on land to the lands and roads in Sandwich West, as the Assessment which might properly be charged on the lands in Sandwich West would not reimburse Sandwich South for cost of duplicate report,

2444.42

Wm. W. Day
Walthamville July 13th 1923

Plans, Estimates and By-Law.

As all the owners on this drain with two exceptions have erected permanent bridges to give access from their property to the Public Highway, I have taken this into consideration in making my Assessment and have placed the sum of \$40.00 in my Assessment required to make the necessary repairs to these bridges to give access to ~~the owners~~ ^{the owners} ~~xxxx xxxxxx~~ in the N.W. $\frac{1}{4}$ of Lot 2 and N.W. $\frac{1}{4}$ of 3.

My Total estimate of this work is \$2374.92

Of this amount I have charged the Municipality of Sandwich South with the sum of ~~\$674.92~~ ^{\$714.92} for Benefit and outlet for Roads and the remaining cost amounting to ~~\$1700.00~~ ^{\$1660.00} on lands which will be benefited by the drain or which may use it for an outlet for these waters as per Assessment, Schedules, etc.

I would recommend that this drain shall be hereafter maintained in the same relative proportion as herein assessed unless future changes in the Drainage area should render changes in Assessment necessary.

Accompanying this report you will please find Plan & Profile Specifications, Estimate of Cost and Schedule of Assessment and Allowances, all of which is respectfully submitted.

I have the honor to be,

Your obedient servant.

C.E.

Walkerville, July 9th, 1915.

Stakes 200 ft apart.

Estimated Cost of proposed repairs and improvements
of the South Talbot and Holden Outlet Drains in the
the Township of Sandwich South, County of Essex, Ont.

Cost of Construction.

From commencement at stake 0 about 800 feet
west of Oldeastle Road as per plan to stake 19 plus
27 feet at the 6th Concession Road.....

232 lin rods of ditching @ \$1.47 cts per rod 345.68
Stake 19 plus 27 ft to stake 41 plus 30 ft
at Holden Outlet Drain,

267 lin rods of ditching @ \$1.51 403.17
Stake 41 plus 30 ft to stake 69 plus 70 ft
at bridge on Town Line Road

344 rods @ \$1.45 per rod 498.80

Stake 69 plus 70 to stake 74 on 4th Con Rd
Sandwich West.

50 rods of drain @ 55¢ per rod 28.50

Branch on East side of 6th Con Road
from Holden Outlet Drain @ 41 plus 30'
to Merrick Creek at stake 41 plus 22

504½ lin rods of drain @ \$1.08 per rod 544.86
Cost of excavation 1821.01

Allowances to Owners for earth spread
on land ~~as per schedule attached~~ 101.16

Extra allowances to Contractor for long haul
in front of Buildings, Orchards etc 50.00

Cleaning out drain at turn of Oldeastle
to South Talbot Drain 5.00

Moving and replacing fences as per Plan
and Specifications 145.50
970 lin rods @ 15 ¢

~~Allowances for bridges to access to road 40.00~~
Allowances for damages to growing crops
meadows &c, if any damages should occur 30.00

331.66
~~371.66~~

	Amount
Incidental charges	
Court of Revision	18.00
Publishing By-Law	20.00
Clerks Fees	30.00
Surveys plans and reports	57.00
Expenses on survey	17.25
Selling and superintending work	80.00

Total incidentals
Total Estimated Cost of Work

222.25
~~244.92~~
2374.92

Owen Mc Kay
Civil Engineer

Schedule of Lands and Roads in the Township of *Sandwich South*
assessed for the *Repairs and Improvements of the South*
Salbot and Holden ~~of the~~ *Outlet Drain*
together with the amount each lot and part of a lot and road should pay towards said

Concession	Lot or part of Lot	Acres	Value of Benefit	Value of Outlet Liability	Value of Injuring Liability	Amount	Name of Owner	Cover Interest for years at per cent.	Total Special Rate	Annual Assessment during each year for years
S.T.R. ^d	Wpt. N $\frac{1}{2}$ 302	40		60 00		60 00	M. McCarthy Est.			
	N.E. $\frac{1}{4}$ 303	50		75 00		75 00	H. Rounding			
	N.W. $\frac{1}{4}$ 303	50		75 00		75 00	Geo. B. Collins			
	Wpt S $\frac{1}{2}$ 302	83	55 00	125 00		180 00	H. O'neil			
	S.E. $\frac{1}{4}$ 303	50	35 00	75 00		110 00	Do			
	S.W. $\frac{1}{4}$ 303	50	35 00	75 00		110 00	Lionel O'neil			
	E. pt S $\frac{1}{2}$ 304	20	15 00	30 00		45 00	Alex. O'neil			
6	W. pt 7	50	45 00	70 00		115 00	Chas. Roadhouse			
	Wpt E pt 7	10		12 50		12 50	Harry O'neil			
	W $\frac{1}{2}$ 6	100	60 00	125 00		185 00	Ed. Banwell			
	Npt W $\frac{1}{2}$ 5	58	35 00	65 00		100 00	Arthur C. Holden			
	S. pt W $\frac{1}{2}$ 5	42	25 00	45 00		70 00	Willard Holden			
	N.W. $\frac{1}{4}$ 4	50	35 00 45 00	40 00 50 00		75 00 95 00	Do			
	S.W. $\frac{1}{4}$ 4	50	30 00 30 00	50 00		70 00	Newton Holden			
	N.W. $\frac{1}{4}$ 3	50	30 00 40 00	35 00 45 00		65 00 85 00	Geo. Holmworth			
	S.W. $\frac{1}{4}$ 3	50	20 00	40 00		60 00	Arch. Hartley			
	N.W. $\frac{1}{4}$ 2	50	15 00	25 00		40 00	Do			
	S.W. $\frac{1}{4}$ 2	30	15 00	15 00		30 00	Do.			
	N.W. $\frac{1}{4}$ 1	20	10 00	5 00		15 00	John Dickson			
5	E. $\frac{1}{4}$ 6	50	20 00			20 00	Alex. Higgins Alex. Higgins			
	W $\frac{1}{2}$ E $\frac{1}{2}$ 6	50	15 00			15 00	Thos. McKee			
	N $\frac{3}{4}$ E $\frac{1}{2}$ 5	75	40 00	37 50		77 50	Ernest Holden			
	S $\frac{1}{4}$ E $\frac{1}{2}$ 5	25		10 00		10 00	Oscar Holden			
	N $\frac{1}{3}$ W $\frac{1}{2}$ 5	33 $\frac{1}{3}$	5 00			5 00	Joe. Edwards			
	M. $\frac{1}{3}$ W $\frac{1}{2}$ 5	33 $\frac{1}{3}$	10 00			10 00	Do			
	S. $\frac{1}{3}$ W $\frac{1}{2}$ 5	33 $\frac{1}{3}$	15 00			15 00	Oscar Holden			
	W $\frac{1}{2}$ 4	50	15 00			15 00	J. Ripley			
Total on lands			590 00	410 00		1700 00				
Municipality			340 00	1090 00		1660 00				
Roads			915 00	374 92		2374 92				
				1464 92		2374 92				
						2414 92				

Owen McFarley
Waverly, July 13th 1925

dw

Walkerville September. 18 1907.

I *Owen McKay* The Engineer appointed by the Municipality of Sandwich South in the County of Essex Province of Ontario under the provisions of the Ditches and Water Courses Act having been required so to do by the requisition of Clem. J. Curtis owner of the South West quarter of Lot 3 and the North West quarter of Lot 2 in the Fifth Concession of Sandwich South representing that he requires certain work to be done under the provisions of said Act for the drainage of said lands and that certain other lands described and roads would be affected.

I attended at the time and place by an appointment in my notice in answer to said requisition and having examined the locality and heard the interested parties find that the drain is required.

The location and description of said ditch or drain being as follows:

The drain was last constructed under an award dated June 13th 1903 and is known as the Curtis Drain. It commences at the line between Lots 3 and 4 in the 5th Concession and extends South along the East side of the Town line ^{Road} between the Townships of Sandwich South and Sandwich West a distance of 352 rods to Merrick Creek. I find that the drain will require to be deepened beyond the original depth and otherwise improved, and to have the depths, widths, slopes, &c shewn on the accompanying Profile.

The extra width required shall be taken from the East side.

On the road side the sod shall not be cut excepting where necessary to remove overhanging earth but the excavation below the bottom of the present ditch shall conform to the slope shewn on Profile. *on both sides.*

The excavated earth shall be cast in the field east of the road ~~or otherwise disposed of by the respective owners~~ ^{respective} but may be spread on the road at the discretion of the Engineer in a few places where the road grade is low and not covered with gravel. The drain as above described shall benefit the following lands.

John Ripley
Timothy Ripley Con V S.W.I/4.4

Nelson Curtis
Isaac Vollans " " S.W.I/4.3

C.J.Curtis " " S.W.I/4.3

Armand Cloutier " " S.W.I/4.2

Arthur Cloutier " " S.W.I/4.1

Edmund Cloutier " " S.W.I/4.1

Mr. Berry Sept 1 10 acres
Mr. Clarke Nov 1 10 acres
H. E. Robbins Sept 1 16 1/2
Mr. Linn Sept 1 10
W. J. Nye Sept 1 5

I do therefore award and apportion the work of constructing the drain and the future maintenance thereof among the lands and roads affected and the owners thereof according to my estimate of their respective interests in the said work as follows:

Timothy Ripley owner of the South West quarter of the West half of Lot 4 in the 5th Concession shall make, complete and thereafter maintain the portion of the drain commencing at stake 0 and extending to stake 2 a distance of 24 rods which I value at \$13.00

Nelson Curtis Isaac Vollans owner of the North West quarter of Lot 3 shall make, complete and maintain the portion of the drain commencing at stake 2 and extending to stake 5 a distance of 36 rods which I value at \$18.72

He shall also make, complete and hereafter maintain that portion of the drain from a point 8 rods South of stake 24 to a point 8 rods South of stake 25 a distance of 12 rods which I value at \$19.50

C.J.Curtis owner of the South West quarter of Lot 3 and the North West quarter of Lot 2, shall make complete and thereafter maintain that portion of the drain from stake 5 to stake 10 a distance of 60 rods which I value at \$33.00

He shall also make, complete and maintain that portion of the drain from a point 9 rods South of stake 22 to a point 8 rods South of stake 24 a distance of 23 rods which I value at \$28.75

Armand Cloutier owner of the South West quarter of Lot 2 in the 5th Concession shall make complete and maintain that portion of the drain from a point 3 rods South of stake 19 to stake 21 a distance of 21 rods which I value at \$26.25

Arthur Cloutier owner of the North West quarter of Lot 1

Shall make complete and hereafter maintain that portion of the drain from stake 21 to a point 9 rods south of stake 22, a distance of 21 rods which I value at \$26.25. Edmund Cloutier owner of the Southwest quarter of Lot I.

Shall make complete and maintain that portion of the drain from a point 8 rods South of stake 25 to Merrick Creek a distance of 42 rods which I value at \$15.00

The Township of Sandwich West joint owner of the Town line road between the Townships of Sandwich East and Sandwich West shall make, complete and maintain that portion of the drain from stake 10 to a point 4 rods South of stake 15 a distance of 64 rods which I value at \$58.75

The Township of Sandwich South joint owner of the Town line road between the Townships of Sandwich South and Sandwich West shall make complete and thereafter maintain that portion of the drain commencing at a point 4 rods South of stake 15 to a point 3 rods South of stake 19 a distance of 47 rods which I value at \$58.75

I further award that each portion of the drain shall be maintained in accordance with the foregoing description and that each party ^{to} of the award shall have his or their portion completed on or before October 15th 1907.

My fees and other charges, attendant upon and for making this award are as follows:

To survey, Assistant, Plan and award	\$20.00
Clerks Fees	<u>4.00</u>
	\$24.00

Amounting in all to \$24.00 which shall be borne and paid by the lands and the respective owners thereof as set forth below and charged as Engineer's Fees.

Timothy Rupley	Engineer's Fees	\$2.50	Clerks Fees	.50
Louis Vollans	"	2.50	"	.50
Clem. J. Curtis	"	2.50	"	.50
Armand Cloutier	"	2.50	"	.50
Arthur Cloutier	"	2.50	"	.50
Edmund Cloutier	"	2.50	"	.50
Sandwich West	"	2.50	"	.50
Sandwich South	"	2.50	"	.50

This shall be known and cited as the Curtis Drain
Ditches and Water Courses Act.

Owen McKay

Township Engineer

Walkerville Sept 18th 1907

40

PLAN AND PROFILE OF THE CURTIS DRAIN TOWNSHIP OF SANDWICH SOUTH COUNTY ESSEX, ONT.

PLAN SCALE 20 Chains to 1 inch
PROFILE SCALES { Hor. 24 Rods to 1 inch.
Vert. 6 feet to 1 inch.

Orin M. May

Civil Engineer

Waltham September 10th 1907

6TH CON: ROAD						
Ernest Holder	E.J. O'Neil	E.J. O'Neil	E.J. O'Neil	Albert Curtis	Albert Curtis	Richard Shiel
Timothy Ripley	Isaac Vollans	C.J. Curtis	C.J. Curtis	Armand Cloutier	Edmund Cloutier	
TOWN		LINE		ROAD		

TP of ANDERDON

TP of SANDWICH WEST

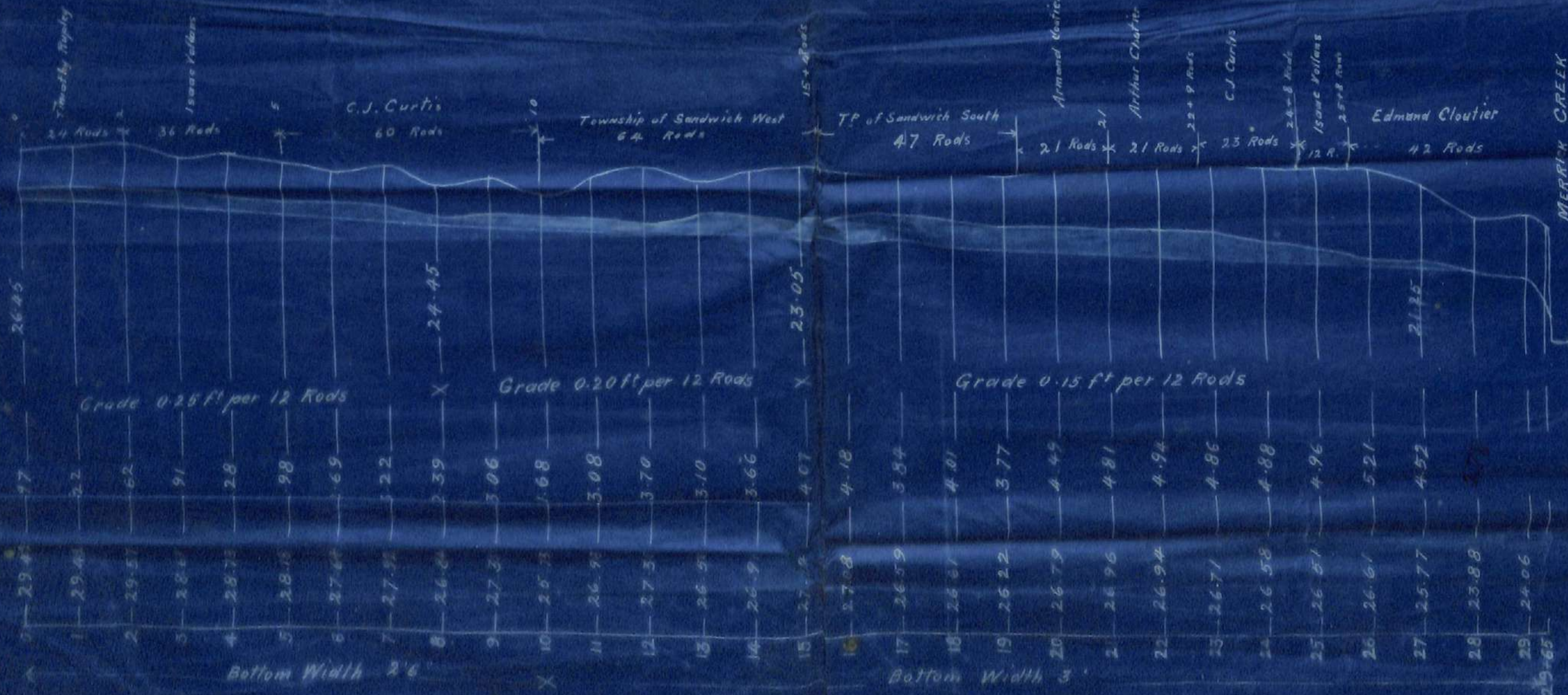

BY-LAW NO. 369

A BY-LAW to provide for Drainage Work in the Township of Sandwich South, in the County of Essex, and for borrowing on the credit of the Municipality the sum of \$2374.72 being the estimated cost of repairing and improving the South Talbot and Holden Outlet Drain.

Provisionally adopted the 24th day of July A. D., 1915

Whereas, Ed. Bamwell served ^{written} notice ~~in writing~~ on the Municipal Council of Sandwich South that the South Talbot and Holden Outlet drain was out of repair.

And Whereas, thereupon the said council has procured an examination to be made by Owen M^cKay being a person competent for such purpose, of the said area proposed to be drained and the means suggested for the drainage thereof, and of other lands and roads liable to assessment under this act, and has also procured plans, specifications and estimates of the drainage work to be made by the said Owen M^cKay and an assessment to be made by him of the lands and roads to be benefitted by such drainage work and of other lands and roads liable for contribution thereto, stating as nearly as he can, the proportion of benefit, outlet liability and injuring liability, which, in his opinion, will be derived or incurred in consequence of such drainage work by every road and lot or portion of lot, the said assessment so made being the assessment hereinafter by this by-law enacted to be assessed and levied upon the roads and lots or parts of lots hereinafter in that behalf especially set forth and described, and the report of the said Owen M^cKay in respect thereof and of the said drainage work being as follows:—

Insert Report Estimates etc

And Whereas, the said Council is of opinion that the drainage of the areas described is desirable.

Therefore, the said Municipal Council of the said Township of Sandwich South pursuant to the provisions of the Municipal Drainage Act, enacts as follows:—

1st. The said report, plans, specifications, assessments and estimates are hereby adopted and the drainage work as therein indicated and set forth shall be made and constructed in accordance therewith.

2nd. The Reeve of the said Township may borrow on the credit of the corporation of the said Township of Sandwich South the sum of \$ 23,749.22 Dollars, being the estimated cost of repairing and improving the South Salted and Holden Outlet drains and may issue debentures of the corporation to that amount in sums of not less than \$50 each, and payable within 10 years from the date thereof with interest at the rate of 6 per centum per annum, that is to say in 10 equal instalments, such debentures to be payable at the Canadian Bank of Commerce, in the City of Windsor, ~~and to have attached to them coupons for the payment of interest.~~

3rd. For paying the sum of \$ 5,700.00 the amount charged against the said lands and roads for benefit, and the sum of \$ 10,900.00 the amount charged against the said lands and roads for outlet liability, and the sum of \$ the amount charged against the said lands and roads for injuring liability, apart from the lands and roads belonging to or controlled by the municipality, and for covering interest thereon for 10 years at the rate of 6 per centum per annum; the total special rate over and above all other rates, shall be assessed, levied and collected (in the same manner and at the same time as other taxes are levied and collected), upon and from the undermentioned lots and parts of lots, and roads and the amount of the said total special rates and interest shall be divided into 10 equal parts and one such part shall be assessed, levied and collected as aforesaid in each year for 10 years after the final passing of this by-law, during which the said debentures have to run.

Concession	Lot or part of Lot.	Acre	Value of Benefit	Value of Outlet Liability	Value of Injuring Liability.	Total of Benefit Outlet Liability and Injuring Liability in each case	Cover Interest for 10 years at 6 per cent.	T'l Special rate	Annual Assess't dur'g each year for 10 years	OWNER
S.T.R.	W 1/4 1/2 302	40		60.00		60.00	21.52	81.52	8.15	M. M. Carthy Est.
	NE 1/4 303	5.0		75.00		75.00	26.90	101.90	10.19	A. Rounding
	NW 1/4 303	5.0		75.00		75.00	26.90	101.90	10.19	Geo B. Collins
	W 1/2 302	83	55.00	125.00		180.00	64.60	244.60	24.46	Frank O. Neil
	SE 1/4 303	5.0	35.00	75.00		110.00	39.45	149.45	14.95	Frank O. Neil
	SW 1/4 303	5.0	35.00	75.00		110.00	39.45	149.45	14.95	Lionel O. Neil
	E pt S 1/2 304	20	15.00	30.00		45.00	16.14	61.14	6.11	Alex. O. Neil
	W pt 7	5.0	45.00	70.00		115.00	41.23	156.23	15.62	Chas. Roadhouse
	E pt 7	10		12.50		12.50	4.50	17.00	1.70	Harry O. Neil
	W 1/2 6	100	60.00	125.00		185.00	66.48	251.48	25.15	Ed. Bannell
	N 1/4 5	5.8	35.00	65.00		100.00	35.87	135.87	13.59	Arthur C. Holden
	S pt 20 1/2 5	42	25.00	45.00		70.00	25.11	95.11	9.51	Willard Holden
	NW 1/4 4	5.0	35.00	40.00		75.00	26.90	101.90	10.19	Willard Holden
	SW 1/4 4	5.0	20.00	50.00		70.00	25.11	95.11	9.51	Newton Holden
	NW 1/4 3	5.0	30.00	35.00		65.00	23.32	88.32	8.83	Geo. Hollinworth
	SW 1/4 3	5.0	20.00	40.00		60.00	21.52	81.52	8.15	Arch. Hartley
	NW 1/4 2	5.0	15.00	25.00		40.00	14.35	54.35	5.44	Arch. Hartley
	SW 1/4 2	30	15.00	15.00		30.00	10.76	40.76	4.08	Arch. Hartley
	NW 1/4 1	20	10.00	5.00		15.00	5.37	20.37	2.04	John Dickson
	S 1/4 6	5.0	20.00			20.00	7.16	27.16	2.72	Afe. Higgins
	W 1/2 E 1/2 6	5.0	15.00			15.00	5.37	20.37	2.04	Thos. McKee
	N 1/4 E 1/2 5	75	40.00	37.50		77.50	27.80	105.30	10.53	Ernest Holden
	S 1/4 E 1/2 5	25		10.00		10.00	3.60	13.60	1.36	Oscar Holden
	N 1/3 W 1/2 5	33 1/3	5.00			5.00	1.80	6.80	.68	Joe Edwards
	W 1/3 W 1/2 5	33 1/3	10.00			10.00	3.60	13.60	1.36	Joe Edwards
	S 1/3 W 1/2 5	33 1/3	15.00			15.00	5.37	20.37	2.04	Oscar Holden
	W 1/2 4	5.0	15.00			15.00	5.37	20.37	2.04	John Ripley
Total on lands			570.00	1090.00		1660.00	595.55	2255.55	225.58	
On Township for Roads			340.00	374.92		714.92	256.27	971.19	97.12	Sp. of Landmark South
Total on lands and roads			910.00	1464.92		2374.92	851.82	3226.74	322.70	

4th. For paying the sum of \$ 714.92 the amount assessed against the said roads and lands of the Municipality, and for covering interest thereon for 10 years at the rate of 6 per centum per annum, a special rate on the dollar, sufficient to produce the required yearly amount therefor, shall, over and above all other rates, be levied and collected (in the same manner and at the same time as taxes are levied and collected), upon and from the whole rateable property in said Township of Sandwich South in each year for 10 years after the final passing of this by-law, during which the said debentures have to run.

5th. That Owen McKay is hereby appointed commissioner to let the contract for the said drain and works connected therewith, by public Auction ^{or tender} to the lowest bidder (not exceeding the estimate), but every such contractor, with two good and satisfactory sureties, shall be required forthwith to enter into bonds for the due performance and completion of the contract, according to said plans and specifications and within the time mentioned within such bond, unless otherwise ordered by the council, and it shall be the duty of such commissioner to cause said drain and works connected therewith, to be made and constructed in accordance with such plans and specifications, ~~not later than the~~ ^{day of} Tuesday A.D., 1915 (unless otherwise ordered by the council), and to grant certificates to the ~~Reeve~~ ^{Treasurer} from time to time, to each contractor, less 40 per cent of the amount due, until the contract is fully completed and duly accepted, and for the due performance of those and all other duties of commissioner, ~~the said commissioner shall be entitled to receive a commission of~~ ^{per cent.} on the actual cost of the work.

6th That a copy of this by-law shall be served on each of the interested parties pursuant to Section 25 of the Municipal Drainage Act and shall come into force upon and after the final passing thereof and may be cited the "South Oulok and Holden Outlet Repairs" by law.

John McAuliffe Clerk.

E. J. O. Mill Reeve.

I hereby certify that the foregoing is a true copy of a By-Law provisionally adopted by the Municipal Council of the said Township of Sandwich South on the 24th day of July A. D., 1915
John McAuliffe
Clerk of the Municipality of Sandwich South.

NOTICE

Notice is hereby given that a Court of Revision, held pursuant to the provisions of the Municipal Drainage Act, for the hearing and trial of appeals made against the above assessment, or any part thereof, will hold its first sittings at Town Hall, Oldeastle, on Saturday the 4th day of September 1915, at the hour of ten o'clock in the forenoon, and that any person intending to appeal against the above assessment, or any part thereof, must, not later than ten days before the time fixed for the holding of said Court, serve on the Clerk of this Municipality, a written notice of such appeal or otherwise he will be too late to be heard in that behalf.

And further notice is hereby given that any person intending to have such By-law, or any part thereof, quashed, must, not later than ten days after the final passing thereof, serve a notice in writing, upon the Reeve or other head officer, and upon the Clerk of the Municipality of Sandwich South of his intention to make application for that purpose, to the Drainage Referee, during the six weeks next ensuing the final passing of this by-law.

John McAuliffe
Township Clerk.